

MMO8000 Bariatric medstrom⁺

Improved Patient Outcomes



MMO[®]
M E D I C A L

ERGONOMICS

The MMO8000 is designed to meet the specific management needs of obese patients.

It provides optimum ergonomic working situations for healthcare providers.

Its multiple functionalities facilitate daily work:

- Significant extent of electrically adjustable height
- Electric Forward sloping/Downward sloping that facilitates repositioning
- Removable headboards to facilitate care
- Compatibility with patient lifts
- The bed is highly manoeuvrable due to the rolling system

RELIABILITY

This bed benefits from the medical expertise of MMO. MMO8000 is the outcome of our team's work which are comprised of clinical experts, design engineers and production engineers.

This bed is in conformance with Standard ISO 60 601-2-52.

The frame of the MMO8000 bed is guaranteed for 10 years. The MMO Hotline is available 24 hours per day, 365 days per year.

COMFORT

The MMO8000 features a very comfortable armchair position that adds dignity to the patient's relationship with healthcare teams and visitors.

This position, which is associated with the movement of the sliding backrest, makes it possible to free the rib cage and improves psychological well-being.

The bed exit height can be personalised and enables patient mobilisation with assistance of the healthcare personnel.

The MMO8000, which is available in three bed widths with the possibility of lengthening, adapts to the morphology of each patient.

SAFETY

The ultra-low position of the bed (21cm) ensures optimum patient safety.

The braking system of the bed is automatic in ultra-low position.

All the electrical functions can be locked by the healthcare personnel.

The safety load of 310kg authorises patient weights of up to 250 kg.



CLINICAL ADVANTAGES

MMO8000 has all the electrical functions that are essential for patient recovery and the working ergonomics of the healthcare personnel.

The bed is systematically equipped with an electric backrest for patient transfers, an electric knee folding system, an electric forward sloping / downward sloping system and a wide range electrically adjustable height system with memorisation of the exit position.



Electric backrest lifts



Electric Forward sloping / Downward sloping



Bed exit memorisation

Release of abdominal compression and prevention of pressure ulcers

The extent of the synchronised sliding back rest **23 cm** of the sleeping surface prevents the complications resulting from the compression of internal organs in the abdominal region. It also reduces the phenomena of "friction" and "shearing" which are responsible for the development of pressure ulcers.

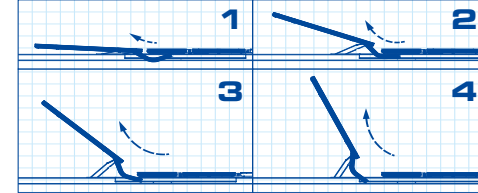
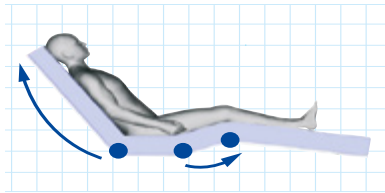

Prevention of infection

The MMO8000 bed was designed to enable quick simple decontamination. Flat removable surfaces enable perfect hygiene. The absence of a low frame and the great manoeuvrability of the bed enables complete accessibility for room cleaning. This configuration enables free access for use of all types of patient lifts.

SAFETY

Different types of side rails

The MMO8000 is equipped with 4-bar ¾ folding rails. These side rails which were validated by the French National Testing Laboratory (LNE) provide patient safety and are in conformance with Standard ISO 60 601-2-52.



MOBILITY, ACCESSIBILITY

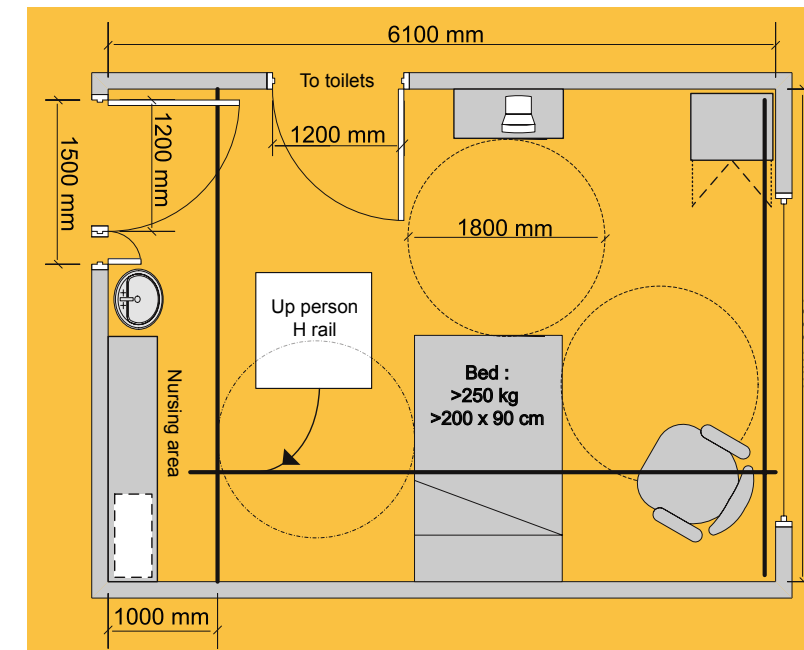

According to the recommendations of the French Health Authorities, facilities that care for obese patients should have mobile adapted hospital equipment.

Among these are:

- Beds with reinforced bases with a minimum admissible load of 250 kg (320 kg in follow-up and rehabilitation care) and a minimum width of 90 cm, ideally from 120 to 140 cm.
- Mattresses with a minimum admissible load of 250 kg.

The dimensions of the room should enable the movement of persons and equipment.

Three bed widths

Headboard for 4-bar ¾ metal side rails

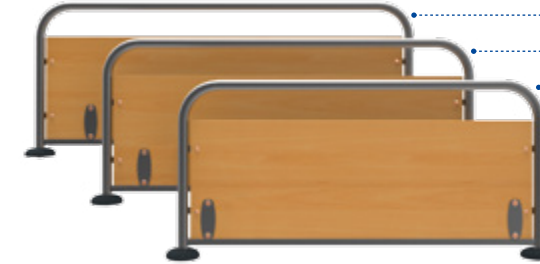

- 120cm bed = 130cm headboard
- 110cm bed = 120 cm headboard
- 100cm bed = 115cm headboard



A wide choice of trims
Consult our colour chart

Headboard for wooden side rails



The MMO8000 is available in three bed widths and can be equipped with a length extension to adapt to the morphology of each patient and thereby provide comfort.

Moving and placement in stretcher position

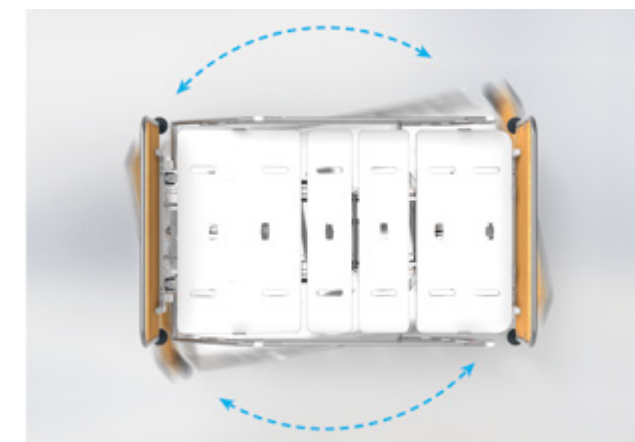

The set of 8 multidirectional castors of 100mm, provides exceptional manoeuvrability. It enables the bed to be moved in all directions without any effort when the room is being cleaned. In directional mode, the MMO8000 bed proves to be even more manoeuvrable and ensures placement in stretcher position by one person.



Multidirectional wheels

TECHNICAL FEATURES

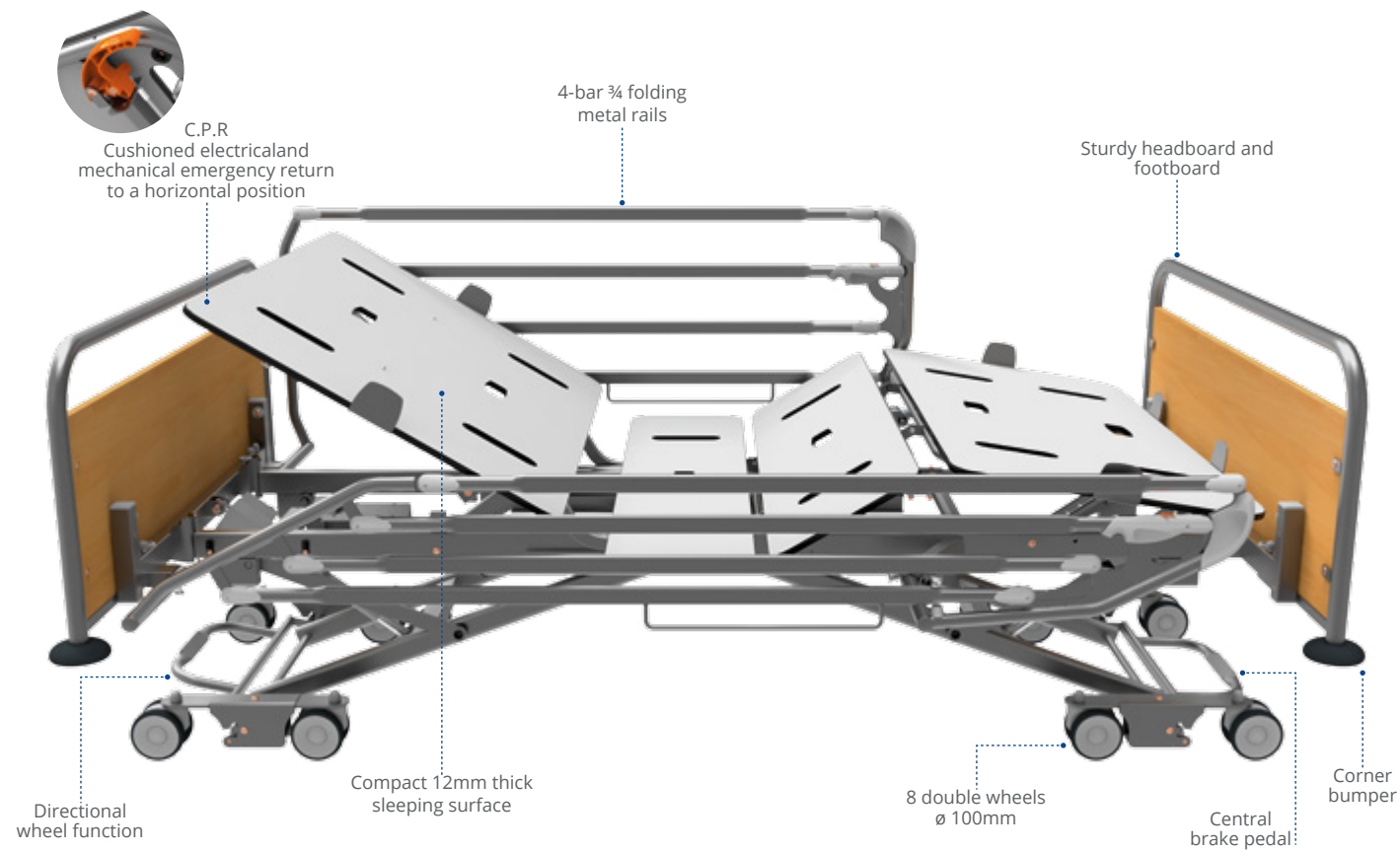

Mattress adapted to heavy loads



Main features

- Sleeping surface length: 200 cm
- Sleeping surface width: 100 - 110 or 120 cm
- Total width x length: 110 - 120 - 130 cm x 214 cm
- Min/max position: 21cm/83 cm
- Forward slope/downward slope: 14°/+14°
- Backrest lift angle: 70°
- Knee folding angle: 30°
- Tilt angle of the leg lift: 20°
- Maximum patient load : 250 kg
- Maximum weight capacity: 340 kg

Standard configuration

- Electric adjustable height and backrest
- Transfer of 23 cm of the backrest lift
- Emergency return to a bilateral horizontal position of the backrest lift (CPR)
- Electric knee folding and associated armchair position
- Wired remote control with selective locking of electrical functions
- Memorisation of the bed exit position
- 4 infusion stands: 2 at the head of the bed and 2 at the foot
- 2 lifting poles at the bed head
- Choice of headboards and footboards
- Central brake at the foot

Options

- 18 cm sleeping surface extension
- Wireless infra-red remote control
- Telescopic wall stop
- Cover holder
- Night light
- Battery

ACCESSOIRES

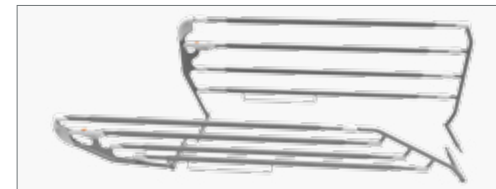

4-bar ¾ folding metal side rails for mattresses up to 25cm thick



Set of padded covers for 4-bar metal side rails



Set of shutters for 4-bar folding side rails



Set of stained wooden side rails



Set of padded covers for wooden side rails



Set of side rail extensions for wooden side rails



Single epoxy finish lifting pole with adjustable grab handle



Single epoxy finish lifting pole with pulley-system grab handle

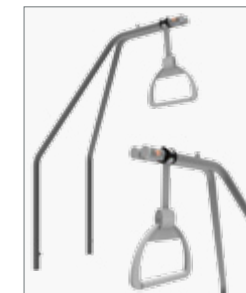

Double epoxy finish lifting pole with pulley-system grab handle



Directional epoxy finish lifting pole with pulley-system grab handle

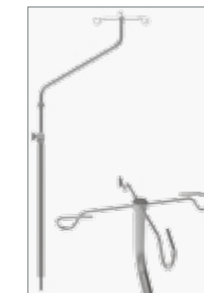

Telescopic 4-hook stainless steel Infusion Stand



2-hook epoxy Infusion Stand



18 cm integrated sleeping surface extension



Retractable wall stop



Remote control stand



Flexible remote control stand



Urinal holder for bed



Bottle holder for bed



Set of accessory support bars

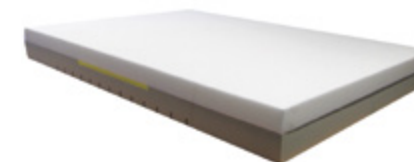

Bariatric Mattress
Dimensions:
100x200x19cm (width 115 cm)
110x200x19cm (width 120 cm)
120x200x19cm (width 130 cm)



Wireless Infra red remote control

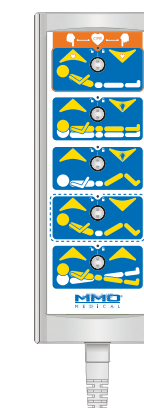

Cabled remote control

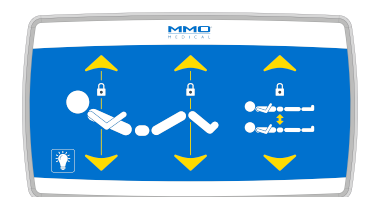

Patient satellite



Caregiver handset with lock-out of electrical functions

Knowing how to meet the needs



Of the patient

- Safety
- Dignity
- Recovery
- Ease of use
- Comfort



Of the decision-maker

- Compliance with standards
- Quality/price ratio
- All-inclusive solution
- Reduction of work-related accidents
- Warranty



Of the healthcare personnel

- Safety
- Cleanability
- Ergonomics
- Simplicity of use
- Clinical training



Of the maintenance personnel

- Technical training
- Reliability
- After-sales service
- Technical support
- Hot Line 24h/day - 7d/week - 365d/year

MMO International is committed to providing the healthcare sector with clinical solutions that meet the specific expectations of residents, healthcare personnel, healthcare facility decision-makers and maintenance personnel.

Our Research & Development expert teams provide effective and innovative solutions designed to improve the lives of the parties concerned.

medstrom⁺

Improved Patient Outcomes



Schweiz

Tel: +41 26 323 20 30

Email: info@medstrom.ch

www.medstrom.ch



Österreich

Tel: +43 2877 930 01

Email: info@medstrom.at

www.medstrom.at

MMO[®]
INTERNATIONAL

HEAD OFFICE, FACTORY AND ADMINISTRATIVE DEPARTMENTS :
24 Route de Beauvais - BP 90148 - 35501 VITRÉ cedex - FRANCE
Téléphone : +33 (0)2 99 75 04 50 - FAX : +33 (0)2 99 74 65 71
Email : info@mmointernational.fr
www.mmointernational.fr



Some of the colours in this document might change according to our colour chart